

No.

**ORDINANCE NO. 2000-09**

**Passed**

January 16, 2001 xxx

19

**AN ORDINANCE REZONING CERTAIN LOTS OF THE REVISED AND CONSECUTIVE NUMBERS OF LOTS OF THE MUNICIPALITY OF BROOKVILLE, OHIO, FROM ITS PRESENT CLASSIFICATION OF "HS" TO THE NEW CLASSIFICATION OF "R-3".**

NOW, THEREFORE, BE IT ORDAINED BY THE COUNCIL OF THE MUNICIPALITY OF BROOKVILLE, OHIO, THAT:

**SECTION I:**

The classification of part Lot #1495, containing approximately 3.3 total acres, located along the north side of Upper Lewisburg-Salem Road approximately 1300 feet north of Upper Lewisburg-Salem Road, from its present classification of "HS" to the new classification of "R-3", as per the Zoning Ordinance of the Municipality of Brookville, Ohio.

See attached map marked Exhibit "A".

**SECTION II:**

This Ordinance shall revoke and rescind all Ordinances, parts of Ordinances; and all Resolutions and parts of Resolutions that are in conflict herewith and shall be enforced from and after the earlier period allowed by law.

PASSED this 16th day of January, 2001.

ATTEST:

  
Sonja M. Keaton, Clerk

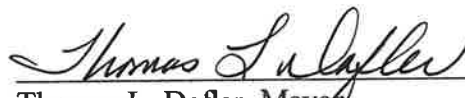
  
Thomas L. Dafler, Mayor

CERTIFICATE

The undersigned, Clerk of the Municipality of Brookville, Ohio does hereby certify that the foregoing is a true and correct copy of Ordinance No.2000-09, passed by the Council of said Municipality on the 16th day of January, 2001.

  
\_\_\_\_\_  
Sonja M. Keaton, Clerk

CERTIFICATE OF POSTING

The undersigned, Clerk of the Municipality of Brookville, Ohio hereby certifies that the foregoing Ordinance No. 2000-09 was posted at the Municipal Building, U.S. Post Office, and the Brookville Branch of the Montgomery County Library, Brookville, Ohio on the 19th day of January, 2001 to the 19th day of February, 2001, both days inclusive.

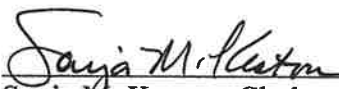
  
\_\_\_\_\_  
Sonja M. Keaton, Clerk



2. LOTS

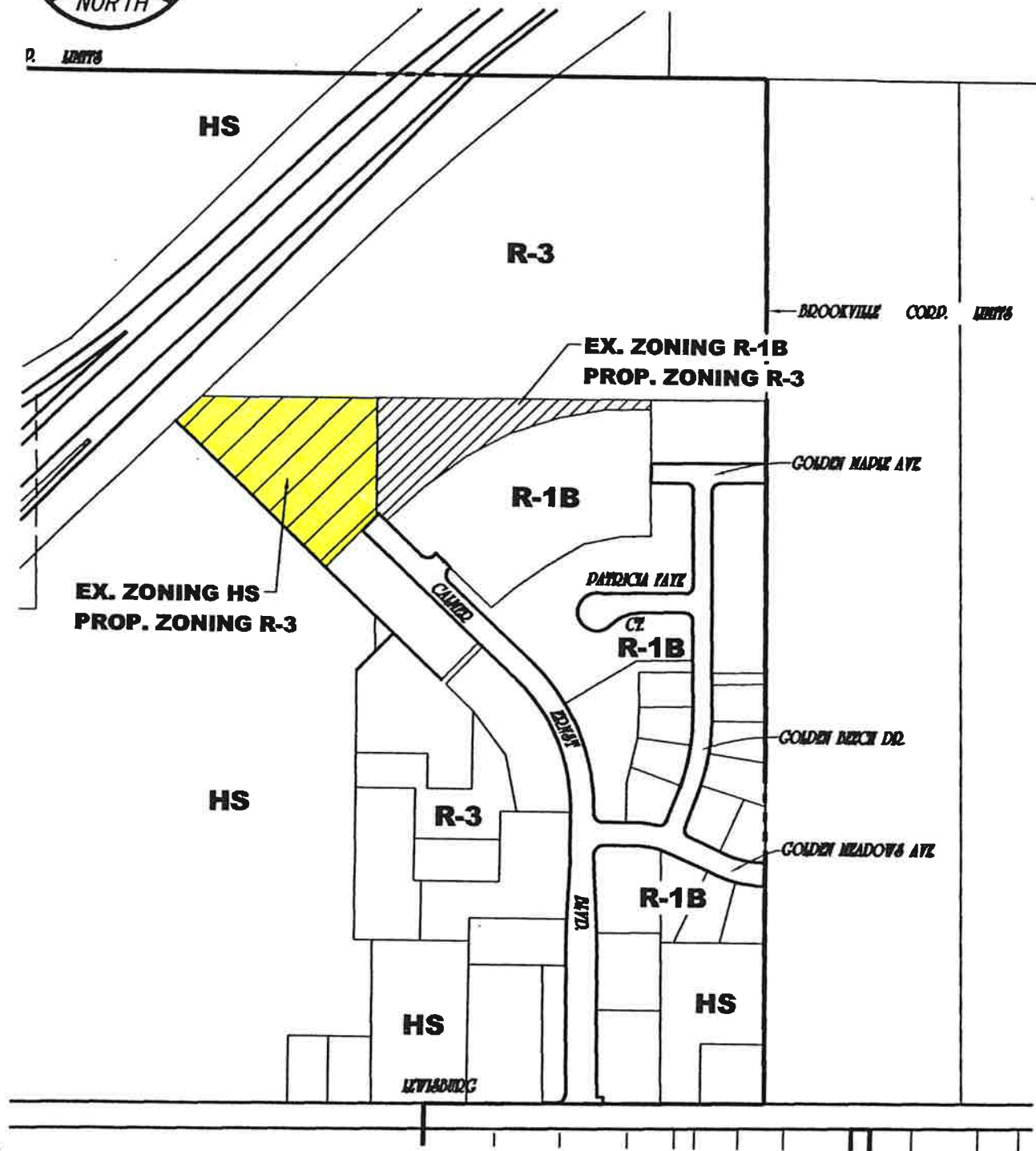

DRAWN BY: D.L.G.

DATE: 11-16-00

DWG. NO.: EXHIBIT "A"

APPROVED BY: T.W.S.

PROJECT

**LMS REALTY, INC**  
**2080 S. ALEX RD.**  
**WEST CARROLLTON, OHIO**

SHT. NAME

**ZONING  
APPLICATION  
MAP**

SHT. NO.

**EXHIBIT  
"A"**