

RECORD OF ORDINANCES

BEAR GRAPHICS 800-325-8094 FORM NO. 30043

2017-12 December 5 17
Ordinance No. _____ Passed _____, 20_____

AN ORDINANCE ESTABLISHING THE MARKET STREET EXTENSION LIGHTING DISTRICT IN THE CITY OF BROOKVILLE.

WHEREAS, Market Street has recently been extended to Upper Lewisburg-Salem Road in the City of Brookville as set forth and described in the map attached hereto as Exhibit "A"; and

WHEREAS, it will be necessary to establish street lighting for the area; and

WHEREAS, City Council desires to adopt this Ordinance to establish the Market Street Lighting District to designate this area as a lighting district, and to approve plans for the provision of street lights in this area; and

NOW, THEREFORE, BE IT ORDAINED BY THE COUNCIL OF THE CITY OF BROOKVILLE, OHIO THAT:

SECTION I: The Market Street Extension Lighting District, as described in the map attached hereto as Exhibit "A", is hereby established.

SECTION II: The Market Street Extension Lighting Plan is hereby approved, and is now on file with the Clerk of Council of the City of Brookville.

SECTION II: It is hereby found and determined that all formal actions of this Council concerning and relating to the passage of this Ordinance were adopted in an open meeting of this Council and that all deliberations of this Council were in meetings open to the public and in compliance with all legal requirements including Section 121.22 of the Ohio Revised Code.

SECTION III: This Ordinance shall take effect thirty (30) days after passage by the Council of the City of Brookville as provided by the Charter of the City of Brookville.

PASSED this 5th day of December, 2017.

ATTEST:



Meghan Wheeler, Clerk



David E. Seagraves, Mayor

RECORD OF ORDINANCES

BEAR GRAPHICS 800-325-8094 FORM NO. 30043

Ordinance No. _____ Passed _____, 20_____

CERTIFICATE

The undersigned, Clerk of the City of Brookville, does hereby certify that the foregoing is a true and correct copy of Ordinance No. 2017-12, passed by the Council of the City of Brookville, Ohio, on the 5th day of December, 2017.



Meghan Wheeler, Clerk

CERTIFICATE OF POSTING

The undersigned, Clerk of the City of Brookville, Ohio, hereby certifies that the foregoing Ordinance No. 2017-12 was posted at the City Building, US Post Office and the Brookville Branch of the Montgomery County Public Library, Brookville, Ohio, on the 8th day of December, 2017, to the 7th day of January, 2018, both days inclusive.



Meghan Wheeler, Clerk

| | | | | | | | | | | |
|-----|----|------|-------|------------|---------------|------|-------------|-------|------------|--------|
| 101 | 20 | 2048 | 13646 | 2025-04-04 | CAD\$ 1885.36 | 46.8 | MAINTENANCE | 13646 | 2025-04-04 | SPRINT |
|-----|----|------|-------|------------|---------------|------|-------------|-------|------------|--------|

THE POWER SUPPLYING AGENCY FOR THIS PROJECT IS:

THE MAINTAINING AGENCY FOR THE STREET LIGHTING CIRCUIT A IS:

THE ENGINEER SHALL ENSURE THAT EACH POWER SERVICE ELECTRICAL ENERGY ACCOUNT IS IN THE NAME OF AND THAT THE BILLING ADDRESS IS TO THE MAINTAINING AGENCY NOTED IN THE PLANS. THIS SHALL BE DONE NOT ONLY FOR EACH NEW POWER SERVICE ESTABLISHED BY THIS PROJECT BUT ALSO FOR EACH EXISTING POWER SERVICE, SINCE THERE MAY BE A REASSIGNMENT OF THE RESPONSIBILITY FOR AN EXISTING SERVICE AS A RESULT OF THE WORK PERFORMED BY THIS PROJECT.

PADLOCKS AND KEYS

ITEM 625, LIGHT POLE, DECORATIVE, AS PER PLAN

PAYMENT WILL BE MADE AT THE UNIT PRICE BID UNDER C&MS ITEM 625, LIGHT POLE, DECORATIVE, AS PER PLAN FOR EACH LIGHT POLE, DECORATIVE, AS PER PLAN WHICH SHALL BE FULL COMPENSATION FOR ALL LABOR, MATERIALS AND INCIDENTALS REQUIRED TO COMPLETE THIS ITEM IN A SATISFACTORY AND WORKMANLIKE MANNER.

IN ADDITION TO THE REQUIREMENTS OF ODOT'S CONSTRUCTION AND MATERIAL SPECIFICATIONS, THE LIGHT POLE, DECORATIVE SHALL BE A PHILIPS LUMEC METROSCAPE 35W 300K LED FIXTURES, OR ENGINEER APPROVED EQUAL.

| | | | | | |
|---|----|---------------|---------------|-----|---------|
| 2 | 10 | MARKET STREET | GENERAL NOTES | MMR | 11/1/20 |
|---|----|---------------|---------------|-----|---------|

FILE NO. MARKET STREET LIGHTS, MARKET STREET, 9/25/2017 9:55:10 AM, SP 0000

| SHEET NUMBER | | | | | | | | | | PARTICIPATION | | ITEM | ITEM EXT. | GRAND TOTAL | UNIT | DESCRIPTION | SEE SHEET NO. | | |
|--------------|-------|--|--|--|--|--|--|--|--|---------------|-----|-------|--------------|----------------|--|-------------|---------------------|-------------------------------------|--|
| 4 | 5 | | | | | | | | | | | | | | | | | | |
| 34 | 12 | | | | | | | | | | 625 | 00450 | 46 | EACH | CONNECTION, FUSED PULL APART | | | | |
| 15 | 4 | | | | | | | | | | 625 | 00460 | 19 | EACH | CONNECTION, UNFUSED PULL APART | | | | |
| 9 | 0 | | | | | | | | | | 625 | 00480 | 9 | EACH | CONNECTION, UNFUSED PERMANENT | | | | |
| 16 | 7 | | | | | | | | | | 625 | 10481 | 23 | EACH | LIGHT POLE, DECORATIVE, AS PER PLAN | 2 | | | |
| 16 | 7 | | | | | | | | | | 625 | 14500 | 23 | EACH | LIGHT POLE FOUNDATION | | | | |
| 8,110 | 2,835 | | | | | | | | | | 625 | 23306 | 10,945 | FT | NO. 10 AWG 600 VOLT DISTRIBUTION CABLE | | | | |
| 224 | 98 | | | | | | | | | | 625 | 23400 | 322 | FT | NO. 10 AWG POLE AND BRACKET CABLE | | | | |
| 2,459 | 920 | | | | | | | | | | 625 | 25402 | 3,379 | FT | CONDUIT, 2", 725.05 | | | | |
| 427 | 0 | | | | | | | | | | 625 | 25502 | 427 | FT | CONDUIT, 3", 725.05 | 2 | | | |
| 16 | 7 | | | | | | | | | | 625 | 27551 | 23 | EACH | LUMINAIRE, DECORATIVE, AS PER PLAN | | | | |
| 2,588 | 920 | | | | | | | | | | 625 | 28002 | 3,488 | FT | TRENCH, 24" DEEP | | | | |
| 17 | 6 | | | | | | | | | | 625 | 30620 | 23 | EACH | PULL BOX, 725.07, SIZE 7 | | | | |
| 16 | 7 | | | | | | | | | | 625 | 32000 | 23 | EACH | GROUND ROD | | | | |
| 1 | 0 | | | | | | | | | | 625 | 34001 | 1 | EACH | POWER SERVICE, AS PER PLAN | 2 | | | |
| 2,886 | 920 | | | | | | | | | | 625 | 36000 | 3,806 | FT | PLASTIC CAUTION TAPE | | | | |
| | | | | | | | | | | | | | | | | | | GENERAL SUMMARY | |
| | | | | | | | | | | | | | | | | | | MARKET STREET EXTENSION LIGHTING | |
| | | | | | | | | | | | | | | | | | | 3 10 | |

| REFERENCE NO. | SHEET NO. | SIDE | CIRCUIT NODES | LOCATION | 625 | 625 | 625 | 625 | 625 | 625 | 625 | 625 | 625 | 625 | 625 | 625 | 625 | 625 | 625 | |
|-----------------------------------|-----------|----------|----------------|----------------------|---------------------------------|-----------------------------------|----------------------------------|---|-----------------------|---|---------------------|---------------------------------------|-----------------|-----------------------------|------------|-------------------------------|----------------------|------------------------|--------------------------------------|--|
| | | | | | CONNECTION, FUSED PULL APART | CONNECTION, UNFUSED PULL APART | CONNECTION, UNFUSED PERMANENT | LIGHT POLE, DECORATIVE, 14', AS PER PLAN | LIGHT POLE FOUNDATION | NO. 10 AWG 600 VOLT DISTRIBUTION CABLE | CONDUIT, 2", 125.05 | LUMINAIRE, DECORATIVE, AS PER PLAN | TRENCH 24" DEEP | PULL BOX, 125.07, SIZE 7 | GROUND ROD | POWER SERVICE, 4S PER PLAN | PLASTIC CAUTION TAPE | CONDUIT, 3", 125.05 | NO. 10 AWG POLE AND BRACKET CABLE | |
| | | | | | EACH | EACH | EACH | EACH | EACH | FEET | FEET | EACH | FEET | EACH | EACH | EACH | FEET | FEET | FEET | |
| 1 | 7 | L.T. | PB-1 | 12+07.21 | 2 | | | | | | | | | | | | | | 14 | |
| 2 | 7 | L.T. | AI-L1 | 12+07.21 | | | | 1 | 1 | 225 | 70 | 1 | 70 | | | | 70 | | | |
| 3 | 7 | L.T. | PB-1 TO PB-2 | 12+07.21 TO 12+77.21 | | 1 | | | | | | | | 1 | | | | | | |
| 4 | 7 | L.T. | PB-2 | 12+77.21 | 2 | | | 1 | 1 | | | 1 | | | | | | | 14 | |
| 5 | 7 | L.T. | AI-L2 | 12+77.21 | | | | | | 255 | 80 | | 80 | | | | 80 | | | |
| 6 | 7 | L.T. | PB-2 TO PB-3 | 12+77.21 TO 13+57.21 | 2 | 1 | | | | | | | | 1 | | | | | 14 | |
| 7 | 7 | L.T. | PB-3 | 13+57.21 | | | | 1 | 1 | | | | | | 1 | | | | | |
| 8 | 7 | L.T. | AI-L3 | 13+57.21 | | | | | | 228 | 66 | | 66 | | | | 66 | 66 | | |
| 9 | 7 | L.T. | PB-3 TO PB-4 | 13+57.21 TO 14+17.21 | | | | | | | | | | | | | | | | |
| 10 | 7 | L.T. | PB-3 TO PB-4 | 13+57.21 TO 14+17.21 | 2 | 1 | | | | | | | | 1 | | | | | 14 | |
| 11 | 7 | L.T. | PB-4 | 14+17.21 | | | | 1 | 1 | | | | | | | | | | | |
| 12 | 7 | L.T. | AI-L4 | 14+17.21 | | | | | | 345 | 110 | | 110 | | | | 110 | 110 | | |
| 13 | 7 | L.T. | PB-4 TO PB-5 | 14+17.21 TO 15+16.18 | | | | | | | | | | | | | | | | |
| 14 | 7 | L.T. | PB-4 TO PB-5 | 14+17.21 TO 15+16.18 | 2 | 1 | | | | | | | | 1 | | | 110 | | | |
| 15 | 7 | L.T. | PB-5 | 15+16.18 | | | | 1 | 1 | | | | | | | | | | 14 | |
| 16 | 7 | L.T. | AI-L5 | 15+16.18 | | | | | | | | | | | | | | | | |
| 17 | 7 | L.T. | PB-5 TO PB-7 | 15+16.18 TO 16+58.24 | | | | | | 441 | 142 | | 142 | | | | 142 | 142 | | |
| 18 | 7 | L.T. | PB-5 TO PB-7 | 15+16.18 TO 16+58.24 | 2 | | | | | | | | | 1 | | | 142 | | 14 | |
| 19 | 7 | RT. | PB-6 | 16+08.18 | | | | 1 | 1 | | | | | | | | | | | |
| 20 | 7 | RT. | AI-L6 | 16+08.18 | | | | | | 291 | | 1 | 92 | | | | 92 | 92 | | |
| 21 | 7 | RT. | PB-6 TO PB-9 | 16+08.18 TO 17+00.18 | | | | | | | | | | | | | | | | |
| 22 | 7 | L.T. | PB-7 | 16+58.24 | | | 3 | | | 66 | 17 | | 34 | | | | 34 | 17 | | |
| 23 | 7 | L.T. | PB-7 TO CCA | 16+58.24 | | | | | | | | | | | | | | | | |
| 24 | 7 | L.T. | CCA | 16+58.24 | | | | | | 141 | 42 | | 42 | | | | 42 | | | |
| 25 | 7 | L.T. | PB-7 TO PB-8 | 16+58.24 TO 17+00.18 | | | | | | | | | | | | | | | | |
| 26 | 7 | L.T. | PB-8 | 17+00.18 | 2 | 1 | 3 | | | | | | | 1 | | | | | 14 | |
| 27 | 7 | L.T. | AI-L7 | 17+00.18 | | | | 1 | 1 | | | | | | | | | | | |
| 28 | 7 | L.T./RT. | PB-8 TO PB-9 | 17+00.18 | | | | | | 157 | | | | | | | | | | |
| 29 | 7 | RT. | PB-9 | 17+00.18 | | | 3 | | | | | | | | | | | | | |
| 30 | 7 | RT. | PB-9 TO PB-10 | 17+00.18 TO 17+92.18 | | | | | | 291 | 92 | | 92 | | | | 92 | | | |
| 31 | 7 | L.T. | PB-9 TO PB-11 | 17+00.18 TO 18+84.18 | | | | | | 567 | 184 | | 184 | | | | 184 | | | |
| 32 | 7 | RT. | PB-10 | 17+92.18 | 2 | 1 | | 1 | 1 | | | | | 1 | | | | | 14 | |
| 33 | 7 | RT. | AI-L8 | 17+92.18 | | | | | | | | | | | | | | | | |
| 34 | 7-8 | RT. | PB-10 TO PB-12 | 17+92.18 TO 19+76.18 | | | | | | 567 | 184 | | 184 | | | | 184 | | | |
| 35 | 7 | L.T. | PB-11 | 18+84.18 | 2 | 1 | | | | | | | | 1 | | | | | 14 | |
| 36 | 7 | L.T. | AI-L9 | 18+84.18 | | | | 1 | 1 | | | | | | | | | | | |
| 37 | 7-8 | RT. | PB-11 TO PB-13 | 18+84.18 TO 20+68.18 | | | | | | 567 | 184 | | 184 | | | | 184 | | | |
| 38 | 8 | RT. | PB-12 | 19+76.18 | 2 | 1 | | | | | | | | 1 | | | | | 14 | |
| 39 | 8 | RT. | AI-L10 | 19+76.18 | | | | 1 | 1 | | | | | | | | | | | |
| 40 | 8 | RT. | PB-12 TO PB-14 | 19+76.18 TO 21+60.18 | | | | | | 567 | 184 | | 184 | | | | 184 | | | |
| 41 | 8 | L.T. | PB-13 | 20+68.18 | 2 | 1 | | | | | | | | 1 | | | | | 14 | |
| 42 | 8 | L.T. | AI-L11 | 20+68.18 | | | | 1 | 1 | 567 | 184 | | 184 | | | | 184 | | | |
| 43 | 8 | L.T. | PB-13 TO PB-15 | 20+68.18 TO 22+52.18 | | | | | | | | | | | | | | | | |
| 44 | 8 | RT. | PB-14 | 21+60.18 | 2 | 1 | | | | | | | | 1 | | | | | 14 | |
| 45 | 8 | RT. | AI-L12 | 21+60.18 | | | | | | | | | | | | | | | | |
| 46 | 8 | L.T. | PB-15 | 22+52.18 | 2 | 1 | | | | | | | | 1 | | | | | 14 | |
| 47 | 8 | L.T. | AI-L13 | 22+52.18 | | | | 1 | 1 | | | | | | | | | | | |
| 48 | 8 | RT. | PB-14 TO PB-16 | 21+60.18 TO 23+44.18 | | | | | | 567 | 184 | | 184 | | | | 184 | | | |
| 49 | 8 | L.T. | PB-15 TO PB-17 | 22+52.18 TO 24+36.18 | | | | | | 567 | 184 | | 184 | | | | 184 | | | |
| 50 | 8 | L.T. | PB-16 | 23+44.18 | 2 | 1 | | | | | | | | 1 | | | | | 14 | |
| 51 | 8 | L.T. | AI-L14 | 23+44.18 | | | | | | | | | | | | | | | | |
| 52 | 8 | L.T. | PB-16 TO PB-18 | 23+44.18 TO 25+28.18 | | | | | | 567 | 184 | | 184 | | | | 184 | | | |
| 53 | 8 | L.T. | PB-17 | 24+36.18 | 2 | 1 | | | | | | | | 1 | | | | | 14 | |
| 54 | 8 | L.T. | AI-L15 | 24+36.18 | | | | 1 | 1 | | | | | | | | | | | |
| 55 | 8 | L.T. | PB-17 TO PB-19 | 24+36.18 TO 26+20.18 | | | | | | 567 | 184 | | 184 | | | | 184 | | | |
| 56 | 8 | RT. | PB-18 | 25+28.18 | 2 | 1 | | | | | | | | 1 | | | | | 14 | |
| 57 | 8 | RT. | AI-L16 | 25+28.18 | | | | | | | | | | | | | | | | |
| 58 | 8 | RT. | PB-18 TO PB-20 | 25+28.18 TO 27+12.18 | | | | | | 567 | 184 | | 184 | | | | 184 | | | |
| 59 | 8 | L.T. | PB-19 | 26+20.18 | 2 | 1 | | | | | | | | | | | | | | |
| TOTALS CARRIED TO GENERAL SUMMARY | | | | | 34 | 15 | 9 | 16 | 16 | 8,110 | 2,459 | 15 | 2,568 | 17 | 16 | 1 | 2,886 | 427 | 224 | |

MARKET STREET
EXTENSION LIGHTING

4
10

LIGHTING SUBSUMMARY

MARKET STREET
EXTENSION LIGHTING

4
10

\\snp\share\11444500\04_C04\101013_Market_Extension.dwg User: jg10 Date: 10/20/2017 9:55:54 AM \$P: cadp1

| REFERENCE NO. | SHEET NO. | SIDE | CIRCUIT NOTES | LOCATION | 625 | 625 | 625 | 625 | 625 | 625 | 625 | 625 | 625 | 625 | 625 | 625 | | | | | | MARKET STREET EXTENSION LIGHTING | LIGHTING SUBSUMMARY | MW FEET | RWY |
|-----------------------------------|-----------|------|----------------|----------------------|---------------------------------|-----------------------------------|---|-----------------------|---|---------------------|---------------------------------------|-----------------|-----------------------------|------------|----------------------|--------------------------------------|--|--|--|--|--|-------------------------------------|---------------------|------------|-----|
| | | | | | CONNECTION, FUSED PULL APART | CONNECTION, UNFUSED PULL APART | LIGHT POLE, DECORATIVE, 14", AS PER PLAN | LIGHT POLE FOUNDATION | NO. 10 AWG 600 VOLT DISTRIBUTION CABLE | CONDUIT, 2", T25-05 | LUMINAIRE, DECORATIVE, AS PER PLAN | TRENCH 24" DEEP | PULL BOX, T25-07, SIZE 7 | GROUND ROD | PLASTIC CAUTION TAPE | NO. 10 AWG POLE AND BRACKET CABLE | | | | | | | | | |
| 60 | 8 | LT. | AI-L17 | 26+20.18 | | | 1 | 1 | 567 | 184 | 1 | | | | 184 | 14 | | | | | | | | | |
| 61 | 8 | LT. | PB-19 TO PB-21 | 26+20.18 TO 28+04.18 | | | | | | | | | | | | | | | | | | | | | |
| 62 | 8 | RT. | PB-20 | 27+12.18 | 2 | 1 | | | | | | | 1 | | | | | | | | | | | | |
| 63 | 8 | RT. | AI-L18 | 27+12.18 | | | 1 | 1 | 567 | 184 | 1 | | | | 184 | 14 | | | | | | | | | |
| 64 | 8 | RT. | PB-20 TO PB-22 | 27+12.18 TO 28+96.18 | | | | | | | | | | | | | | | | | | | | | |
| 65 | 8 | LT. | PB-21 | 28+04.18 | 2 | 1 | | | | | | | 1 | | | | | | | | | | | | |
| 66 | 8 | LT. | AI-L19 | 28+04.18 | | | 1 | 1 | 567 | 184 | 1 | | | | 184 | 14 | | | | | | | | | |
| 67 | 8-9 | LT. | PB-21 TO PB-23 | 28+04.18 TO 29+88.18 | | | | | | | | | | | | | | | | | | | | | |
| 68 | 8 | RT. | PB-22 | 29+96.18 | 2 | 1 | | | | | | | 1 | | | | | | | | | | | | |
| 69 | 8 | RT. | AI-L20 | 29+96.18 | | | 1 | 1 | 567 | 184 | 1 | | | | 184 | 14 | | | | | | | | | |
| 70 | 8-9 | RT. | PB-22 TO PB-24 | 28+96.18 TO 30+80.18 | | | | | | | | | | | | | | | | | | | | | |
| 71 | 9 | LT. | PB-23 | 29+88.18 | 2 | 1 | | | | | | | | | | | | | | | | | | | |
| 72 | 9 | LT. | AI-L21 | 29+88.18 | | | 1 | 1 | 567 | 184 | 1 | | | | 184 | 14 | | | | | | | | | |
| 73 | 9 | LT. | PB-23 TO PB-25 | 29+88.18 TO 31+72.18 | | | | | | | | | | | | | | | | | | | | | |
| 74 | 9 | RT. | PB-24 | 30+80.18 | 2 | | | | | | | | | | | | | | | | | | | | |
| 75 | 9 | RT. | AI-L22 | 30+80.18 | | | | | | | | | 1 | | | | | | | | | | | | |
| 76 | 9 | LT. | PB-25 | 31+72.18 | 2 | | | | | | | | | | | | | | | | | | | | |
| 77 | 9 | LT. | AI-L23 | 31+72.18 | | | 1 | 1 | | | 1 | | | | | | | | | | | | | | |
| TOTALS CARRIED TO GENERAL SUMMARY | | | | | 12 | 4 | 7 | 7 | 2,835 | 920 | 7 | 920 | 6 | 7 | 920 | 98 | | | | | | | | | |

- NOTES:**
1. ALL CONDUIT IS 2" PVC UNLESS NOTED.
 2. POLE LOCATIONS HAVE BEEN DETERMINED AS ACCURATELY AS POSSIBLE. TOP OF POLE FOUNDATIONS SHALL BE FLUSH WITH ADJACENT WALK WAYS.
 3. PULL BOXES AT POLE LOCATIONS NOT SHOWN FOR CLARITY. PULL BOXES SHALL BE INSTALLED AT EACH LIGHT POLE LOCATION.

STA. 10+00.00 MARKET STREET =
STA. 104+00.00 SALEM STREET

MARKET ST.

SALEM ST.

MARKET ST.

N 39° 49' 14" W

N 50° 00' 15" E

4 STA. 12+77.21, 24.00' LT.
PULL BOX, PB-2

7 STA. 13+57.21, 24.00' LT.
PULL BOX, PB-3

5 STA. 12+77.21, 22.38' LT, AI-L2
IES IV, 35W, 14', 0

8 STA. 13+57.21, 22.38' LT, AI-L3
IES IV, 35W, 14', 0

1 STA. 12+07.21, 24.00' LT.
PULL BOX, PB-1

2 STA. 12+07.21, 22.38' LT, AI-L1
IES IV, 35W, 14', 0

APPROXIMATE DP&L
TRANSFORMER LOCATION

3" CONDUIT

MATCH LINE STA. 14+00.00

11 STA. 14+17.21, 24.00' LT.
PULL BOX, PB-4

12 STA. 14+17.21, 22.38' LT, AI-L4
IES IV, 35W, 14', 0

15 STA. 15+16.18, 24.00' LT.
PULL BOX, PB-5

16 STA. 15+16.18, 22.38' LT, AI-L5
IES IV, 35W, 14', 0

24 STA. 16+58.24, 43.71' LT.
CONTROL CENTER A - CCA

22 STA. 16+58.24, 24.00' LT.
PULL BOX, PB-7

26 STA. 17+00.18, 24.00' LT.
PULL BOX, PB-8

27 STA. 17+00.18, 22.38' LT, AI-L7
IES IV, 35W, 14', 0

35 STA. 18+84.18, 24.00' RT.
PULL BOX, PB-11

36 STA. 18+84.18, 22.38' RT, AI-L9
IES IV, 35W, 14', 0

MARKET ST.

N 0° 28' 06" E

29 STA. 17+00.18, 24.00' RT.
PULL BOX, PB-9

20 STA. 15+08.18, 22.38' RT, AI-L6
IES IV, 35W, 14', 0

19 STA. 16+08.18, 24.00' RT.
PULL BOX, PB-6

33 STA. 17+92.18, 22.38' RT, AI-L8
IES IV, 35W, 14', 0

32 STA. 17+92.18, 24.00' RT.
PULL BOX, PB-10

LEGEND



PROPOSED LIGHT POLE AND LUMINAIRE
AND FOUNDATION



PROPOSED 2" CONDUIT 725.05
UNLESS OTHERWISE NOTED ON PLANS



PROPOSED PULL BOX



PROPOSED CONTROL CENTER

LIGHTING PLAN

STA. 10+00.00 TO STA. 19+00.00

**MARKET STREET
EXTENSION LIGHTING**



1" = 10'

1" = 10'

1" = 10'

1" = 10'

1" = 10'

1" = 10'

1" = 10'

1" = 10'

1" = 10'

1" = 10'

1" = 10'

1" = 10'

1" = 10'

1" = 10'

1" = 10'

1" = 10'

1" = 10'

1" = 10'

1" = 10'

1" = 10'

1" = 10'

1" = 10'

1" = 10'

1" = 10'

1" = 10'

1" = 10'

1" = 10'

1" = 10'

1" = 10'

1" = 10'

1" = 10'

1" = 10'

1" = 10'

1" = 10'

1" = 10'

1" = 10'

1" = 10'

1" = 10'

1" = 10'

1" = 10'

1" = 10'

1" = 10'

1" = 10'

1" = 10'

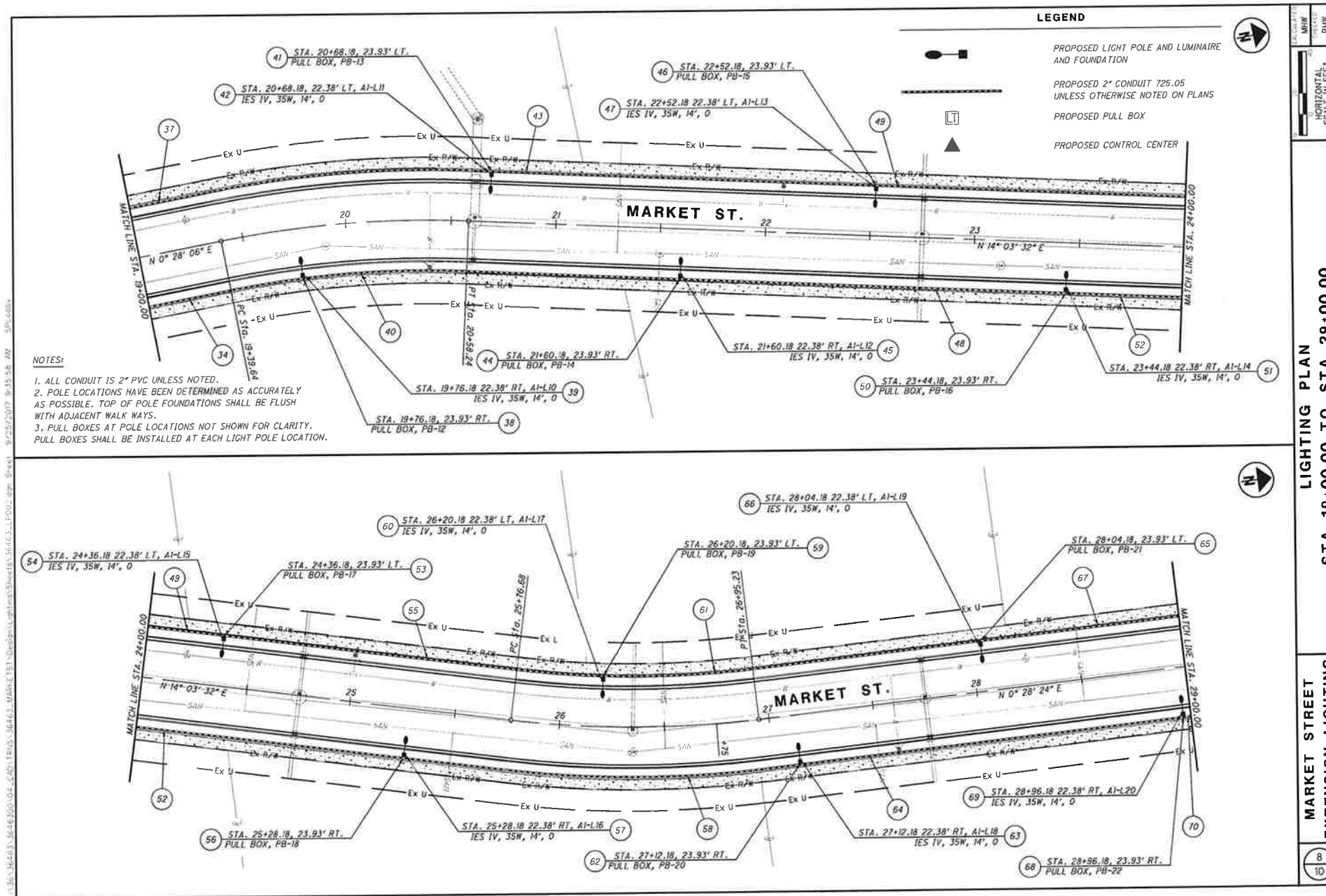

F:\36136143\36143\001\CDN\10-23-2016\1151\Design\1151.dwg Sheet 9/29/2017 9:36:00 AM

LEGEND

- PROPOSED LIGHT POLE AND LUMINAIRE AND FOUNDATION
- PROPOSED 2" CONDUIT 725.05 UNLESS OTHERWISE NOTED ON PLANS
- PROPOSED PULL BOX
- PROPOSED CONTROL CENTER

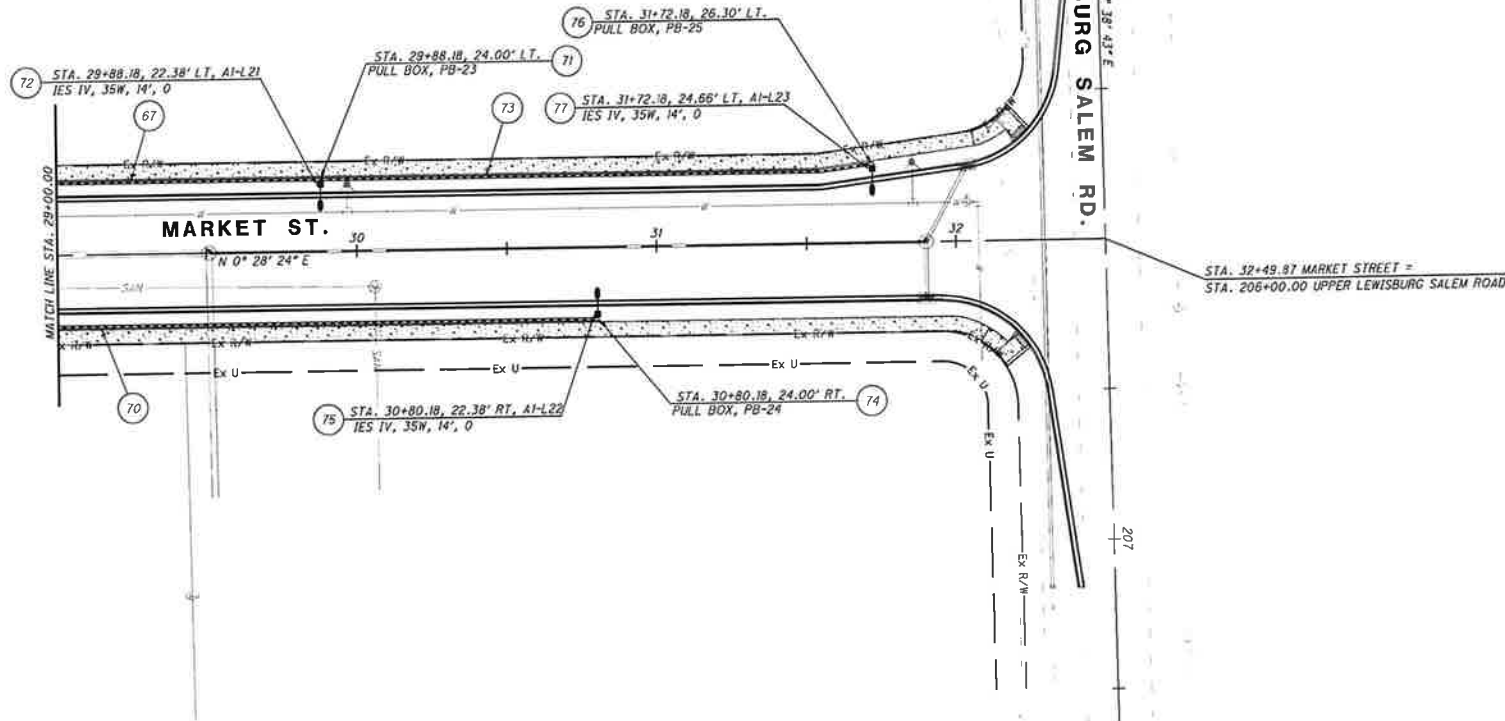

NOTES:

1. ALL CONDUIT IS 2" PVC UNLESS NOTED.
2. POLE LOCATIONS HAVE BEEN DETERMINED AS ACCURATELY AS POSSIBLE. TOP OF POLE FOUNDATIONS SHALL BE FLUSH WITH ADJACENT WALK WAYS.
3. PULL BOXES AT POLE LOCATIONS NOT SHOWN FOR CLARITY. PULL BOXES SHALL BE INSTALLED AT EACH LIGHT POLE LOCATION.



MARKET STREET
EXTENSION LIGHTING

MARKET STREET
EXTENSION LIGHTING

9
10

